



## **WATER TITE NO.1™**

(Integral Waterproofing Powder)

**Water Tite No.1** is a chloride free powder, which seals the capillary pores of concrete and cement mortars, thereby blocking water seepages. It is water insoluble and therefore becomes a permanent constituent of hardened concrete. It also increases workability.

**SPECIFICATION:** Conforms to IS 2645-1975

**WHERE TO USE:** Water Tite No. 1 can be used in all cement works like RCC, slabs, plaster etc.

**HOW TO USE:** Mix sand and cement as required (ratio of 0.45 for best result). Add Water Tite No.1 powder and remix. Add stone aggregates for concrete and remix. Add water and mix thoroughly to obtain cohesive mix of concrete.



①

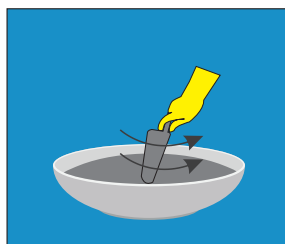

②

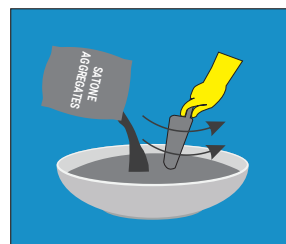

③



④

### **ADVANTAGES:**

- Can be used for concrete as well as mortars.
- Only Water Tite No.1 has an active chemical that waterproofs cement effectively. Does not contain lime stone powder.
- Mixes uniformly and thoroughly with cement to make it cohesive and waterproof.
- Economical-A small quantity is enough to make concrete mortar waterproof.
- Packed in durable pouches- No pilferage like other waterproofing powder.
- Uses worldwide proven formula.

**PRECAUTION:** Mix Water Tite No.1 powder in pre-measured cement/sand ratio, then mix it properly before adding water for best result.

**DOSAGE:** 1 packet of 1kg for 50kg bag of cement mix.

**STORAGE:** Store in cool & dry place, away from direct sunlight.

SHELF LIFE:	PACKAGING:
24 months from the date of manufacture.	1kg pouch, 25 pouches master bag, 25 kg bulk pack.



**Corporate Office:**

601, Corporate Arena, Off. Aarey Piralal Cross Rd., Goregaon (W), Mumbai - 400104  
**Tel:** 022-46038393 **Email:** [info@aquaproofindia.com](mailto:info@aquaproofindia.com) | **Website:** [www.aquaproofindia.com](http://www.aquaproofindia.com)



## AQUAPROOF LWP®

(Integral Waterproofing Liquid)

**Aquaproof LWP** makes concrete resist water even through hydrostatic pressure or capillary absorption. This is done by disrupting the capillary network within the concrete, thus making the concrete impermeable. It also reduces water demand significantly.

**WHERE TO USE:** Aquaproof LWP is a very good construction chemical for waterproofing work of any kind of cement work, especially concrete work. It will work for big size construction or small construction work.

**HOW TO USE:** It should be added to the mixing water for addition to mortar and not to dry cement or dry mortar. Use normal mixing time.

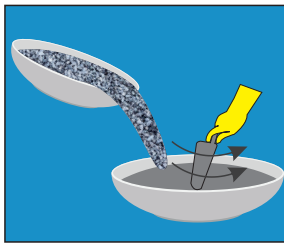

①



②



③



④

### ADVANTAGES:

- Water resistant either through pressure or capillary action.
- Durable due to lower water cement ratio.
- Resists sulphate attacks.
- Better pumpability.
- Superior surface finish.

**PRECAUTION:** Maintain proper water cement ratio. Pour concrete quickly and compact thoroughly. Protect against rapid drying. Cure thoroughly. Store in frost-free environment. It is vitamin for concrete.

**DOSAGE:** Add 100ml of Aquaproof LWP for work of one 50kg bag of cement. Over dosage will slightly set retardation, increase air content slightly and reduce compressive strength but leads to better workability.

**PACKAGING:**

100ml bottle, 500ml, 1 & 5Ltr cans, 10, 20 & 210Ltr drums.

**TECHNICAL SPECIFICATIONS:**

PROPERTIES	RESULT
Appearance	Dark brown liquid
Base	Sodium ligno sulphonate base
Specific gravity	1.11 to 1.12
pH	10 to 11
Solid content	20 ± 2%
Chloride Content as per- (%) - (%) (IS:2645-2003)	Max. 2%
Setting time, minutes- (As per IS:2645-2003)	Pass
Water permeability	Pass

**Corporate Office:**

601, Corporate Arena, Off. Aarey Piramal Cross Rd., Goregaon (W), Mumbai - 400104  
 Tel: 022-46038393 Email: [info@aquaproofindia.com](mailto:info@aquaproofindia.com) | Website: [www.aquaproofindia.com](http://www.aquaproofindia.com)



## **AQUAFIN 2K™**

(Two Component Waterproof Coating)

**AquaFin 2K** is a flexible, acrylic polymer modified, cement-based, two component waterproofing coating. It can be applied over concrete and masonry surfaces. It is easy to use and economical. This system comprises cement-based grey powder and acrylic polymer in liquid form, both supplied in pre-measured quantity. It can be applied by ordinary brush.

**RAW MATERIALS:** AquaFin 2K powder contains white/grey cement, meticulously selected grades of quartz-based extenders, waterproofing agents, polymeric bonding agents. Its liquid contains acrylic polymer, preservatives and defoamers.

**WHERE TO USE:** AquaFin 2K can be used in bathrooms, top floor ceiling, swimming pools and water tanks. It is ideal for box type waterproofing. It can also be applied on external surface since it provides excellent resistance to carbonation attacks.

### **HOW TO USE:**

**(A) SURFACE PREPARATION:** The surface should be free from oil, grease, dust, debris or any foreign particles. It should be cleaned mechanically using a brush or sand blasting etc. and finally the loose particles must be cleaned by pressure water jetting or with an air blower. Surface cracks more than 1mm should be sealed with Krackfill crack filler.

**(B) APPLICATION:** AquaFin 2K is supplied in pre-measured ratio 2kg of powder to 1kg of liquid by weight. Pour the liquid in a bucket or vessel. Add the powder gradually under continuous stirring till you get a brushable consistency. Apply the first coat of AquaFin 2K mix prepared as described above, by brush over the prepared surface. Allow it to dry for 4-6 hours. The second coat should be applied at right angle to the completely dried first coat. AquaFin 2K coating should be cured for four days.

### **ADVANTAGES:**

- It is cement and polymer based so it is eco-friendly and non-flammable.
- It is flexible and hence deflections in surface do not affect the coating.
- It can be applied to water tanks too since it is non-hazardous.
- It is a do-it-yourself product. It does not require skilled labour.
- It is not affected by carbonation attacks.

**COVERAGE:** 3kg. of AquaFin 2K mix, i.e. in the ratio of 2kg of powder and 1 kg of liquid will cover approximately 15-20sq.ft. per two coats.

**STORAGE:** Keep AquaFin 2K in a cool, dry place. Protect the material from direct sunlight.

**PRECAUTIONS:** Clean the tools with potable water before the material sets.

SHELF LIFE:	PACKAGING:
For best results, use within one year from the date of manufacturing.	3 kg & 15 kg buckets.

#### TECHNICAL SPECIFICATIONS:

PROPERTIES	RESULT
Physical Appearance	Part A- Free Flowing Grey/Off White Powder Part B- White Liquid
Bulk Density (Part A)	1.25
Specific Gravity (Part B)	1.02
Solid Content (Part B)	40 ± 2%
Pot Life	45Min.@27°C.
Adhesion to Concrete	>1 N/mm <sup>2</sup>

#### Corporate Office:

601, Corporate Arena, Off. Aarey Piramal Cross Rd., Goregaon (W), Mumbai - 400104  
 Tel: 022-46038393 Email: [info@aquaproofindia.com](mailto:info@aquaproofindia.com) | Website: [www.aquaproofindia.com](http://www.aquaproofindia.com)



## AQUA SEAL™

(Crystallizing Waterproofing)

**Aqua Seal** is a cement-based, reddish in colour, single component water proofing coating using crystallizing method. It is easy to use and economical. It comprises of cement and thus it has excellent bonding. It requires only onsite addition of water and can be applied with an ordinary brush.

**WHERE TO USE:** Aqua Seal can be applied over concrete, masonry & other cementitious surfaces.

### HOW TO USE:

**(A) SURFACE PREPARATION:** The surface should be free oil, grease, dust debris or any foreign particles. It should be cleaned mechanically using a brush, sand blasting etc. and finally the loose particles must be cleaned by pressure water jetting or with an air blower. Surface cracks of more than 5mm should be sealed with Aqua Seal modified mortar.

**(B) MIXING:** Mix Aqua Seal, cement and clean sand in a volumetric ratio of 1:1:4 and dry mix it properly. Aqua Seal powder drymix is to be mixed with water at a volumetric ratio of 3:1. Take the required quantity of water in a clean ghamela or bucket and add the powder to it gradually under continuous stirring till you get a brushable consistency.

**(B) APPLICATION:** Apply the first coat of **Aqua Seal** part/mix, prepared as described above, by brush over the prepared surface. Allow it to dry for 4-6 hours. The second coat should be applied at right angle to the completely dried first coat. **Aqua Seal** coating should be cured for four days.



①



②

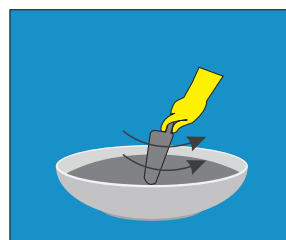

③



④

**ADVANTAGES:**

- It is cement based so it is eco-friendly and non-flammable.
- It can be applied for both positive and negative water pressure.
- Since it is non-hazardous, Aqua Seal can be applied in potable water tanks too.
- It is a do-it-yourself product. It does not require skilled labour.
- It contains crystallizing agents that remain active for a very long period thus prevents water leakage in the future too.

**COVERAGE:** 1kg of Aqua Seal prepared as above will cover 10-12 sq.ft. in a single coat at 2mm thickness.

**STORAGE:** Keep Aqua Seal in a cool, dry place. Protect the material from direct sunlight.

**PRECAUTIONS:** Clean the tools with potable water before the material sets.

SHELF LIFE:	PACKAGING:
For better results use within one year from the date of manufacturing.	20kg bag.

**Corporate Office:**

601, Corporate Arena, Off. Aarey Piralal Cross Rd., Goregaon (W), Mumbai - 400104  
**Tel:** 022-46038393 **Email:** [info@aquaproofindia.com](mailto:info@aquaproofindia.com) | **Website:** [www.aquaproofindia.com](http://www.aquaproofindia.com)



## **AQUA CRETE 151™**

(Latex Polymer)

**Aqua Crete 151** is a white colour liquid acrylic polymer latex specially designed for use as an admixture for cementitious mortar and concrete to improve the bonding, flexibility and workability. It can also be used as a bonding coat and for excellent waterproofing in combination with cement, for increasing the bond between new concrete with old concrete, plaster repairs and screeds.

**WHERE TO USE:** Aqua Crete 151 is latex powered and hence can be used anywhere and any type of building an bonding in new construction and filling joint of new and old construction. It is excellent material for water proofing. Just add normal 53 grade cement and apply for floor and bathroom, sunken waterproofing.

**HOW TO USE:** Aqua Crete 151 can be used in various applications. Following guidelines are for structural rehabilitation.

### **ADVANTAGES:**

- Easy to use- Just add normal OPC 53 cement at site.
- Economical.
- Durable.
- Perfect waterproofer.
- Multipurpose bonding agent.
- Very good for joint of new and old concrete.

<b>SHELF LIFE:</b>	<b>PACKAGING:</b>
Best use before 12 months from the date of manufacturing.	500ml, 1 & 5 Ltr cans, 10, 20 & 210Ltr drums.

**TECHNICAL SPECIFICATIONS:**

APPLICATION	PROPORTION	YIELD
Waterproof/Protective Coating Passivator Coat	3kg fresh OPC, 1 Ltr Aquacrete, 0.4 Ltr water	4 to 6 sq.metre per Ltr of Aquacrete
Bond Coat	3 kg OPC, 3 kg Zone II sand, 1 Ltr Aquacrete, 0.6 Ltr water	5 to 7 sq.metre per Ltr of Aquacrete
Repair Mortar	25 kg OPC, 62.5 kg Zone II sand, 3 Ltr Aquacrete, 3 to 5 Ltr water	0.04 cu.m
Injection	2 parts fresh OPC, 1 part Aquacrete	1.5 Ltr
Screed	4.5 kg fresh OPC, 7.5 kg zone II sand, 1 Ltr Aquacrete, 0.6 Ltr water	1.1 to 1.4 sq.metre at 5mm thickness

**Corporate Office:**

601, Corporate Arena, Off. Aarey Piralal Cross Rd., Goregaon (W), Mumbai - 400104  
 Tel: 022-46038393 Email: [info@aquaproofindia.com](mailto:info@aquaproofindia.com) | Website: [www.aquaproofindia.com](http://www.aquaproofindia.com)



## AQUA DAMP™

(Polymer Based Damp Proof Coating)

**Aqua Damp** is an optimal blend of high quality acrylic binder, premium grade pigments, combined with rheology modifiers and water proofing chemicals. This provides excellent waterproof, tough and flexible decorative and protective coating.

**WHERE TO USE:** Ideally suited for application on plaster, bricks, blocks, roughcast plaster block. Waterproofing of parapets, outer walls, chajjas, internal and external plastered surfaces. For sealing hairline cracks and pores on surface. For damp patches on the plastered surface of internal walls.

**HOW TO USE:** Always stir the material well before use. Apply first coat of Aqua Damp Proof with the paint brush directly on the prepared surfaces. Allow to dry minimum 4-5 hours. Apply second coat.

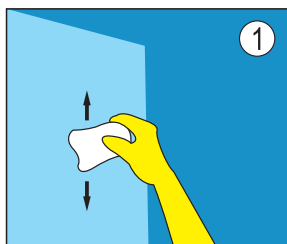

Ensure that the surface to be treated is thoroughly clean, free from oil, grease, dirt, dust or any other surface contamination.

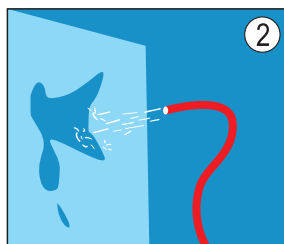

Thoroughly clean the prepared surface with fresh water before applying Aqua damp proof coating.

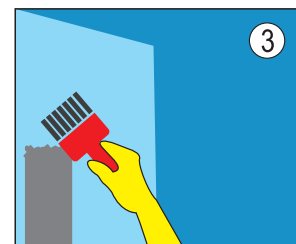

Coat the required area evenly. Minimum two coats needed.

### ADVANTAGES:

- Single component, ready to use material, available in white-base.
- Extremely good waterproof, weatherproof and can be applied on damp surfaces.
- Seals all hairline cracks, pores etc. on surfaces.
- Excellent adhesion, withstands expansions and contractions, movements of plastering/concrete surface without deforming, cracking, softening and peeling.
- Resistant to mild acids, detergents and fungus etc.
- Easy to use, brushable and also economical.

**COVERAGE:** 70-80 sq.ft. per ltr/coat

**STORAGE:** Keep Aqua Damp Proof in a cool & dry place.

**PRECAUTIONS:** Protect the material from direct sunlight. Clean the tools with potable water before the material sets.

SHELF LIFE:	PACKAGING:
12 months from the date of manufacture.	Aqua Damp Proof is available in 500g & 1lt can & 20 lt bucket.

#### TECHNICAL SPECIFICATIONS:

PROPERTY	RESULT
Appearance	Ready to use viscous liquid
Colour	White
Density	1.25
Finish	Smooth and Matt
Drying time	6 - 8 hours
Dry film thickness	100-120 micron with 2 coats
Coverage	2.3-2.7 sq.ft. for 2 coats

#### Corporate Office:

601, Corporate Arena, Off. Aarey Piramal Cross Rd., Goregaon (W), Mumbai - 400104  
Tel: 022-46038393 Email: [info@aquaproofindia.com](mailto:info@aquaproofindia.com) | Website: [www.aquaproofindia.com](http://www.aquaproofindia.com)



## **COOL COOL THANDA THANDA™**

(Heat Reducing & Water Proofing Coating)

**Cool Cool Thanda Thanda** is a revolutionary single component white colour powder coating material with excellent properties. Aquaproof Cool Cool Thanda Thanda when applied on any surface effectively reduces the temperature. It also fills minor cracks which stops leakage. It can also be used to seal plumbing/other joints. A unique formulation makes the product very effective.

**WHERE TO USE:** Any plain cement surface with direct access to sunlight. New and old concrete roof/terrace of buildings. Water-tanks, crack in parapet walls, and the attachment of roof membranes to parapet walls, asbestos-cement sheet roofs/walls. Industries, garages, water pipes, cinema halls, pavements, cold storages.

**HOW TO USE:** Remove all the loosely particulate material and dust from the surface with wire brush and wash the surface properly with clean water. Allow the surface to dry completely before application of Aquaproof Cool Cool Thanda Thanda. Big cracks, if any, on the surfaces should first be filled by Aquaproof Crack Fill. Mix powder in water in the ratio of 1:1 to prepare proper slurry usable by brush on top of a roof. Application should be done in the morning or evening (avoid afternoons when temperatures are high). After drying of the first coat of slurry horizontally/vertically with a brush apply the 2nd coat in reverse direction. Allow the surface to dry for at least 4 hrs before second coat. Use the prepared slurry within two hours. It is advisable to take fresh material for each coat of application. For sealing plumbing/other joints use Aqua Crete & apply a thicker paste of Aquaproof Cool Cool Thanda Thanda.

**COAT COVERAGE:** 20-25 sq.ft. in 2 coats in 1kg

### **ADVANTAGES:**

- Reduces your indoor temperature and make you Cool Cool.
- Reduces your Electricity Expenses.
- Protects your building surfaces from leakage/seepage.
- Extends the life of your roof and other surfaces.
- Reduces temperature of water in storage tanks.

- Increases life of slab by protecting reinforcement steel.
- No inconvenience to occupants.
- Simple & easy to apply, can be applied by low skilled painter.
- Applied by painting normal brush.
- Durable & low coast coating with added advantages of crack seal and waterproofing.

**STORAGE:** Store in a cool, dry place. Keep the drum tightly closed between usages.

SHELF LIFE:	PACKAGING:
Best use before 12 months from the date of manufacturing.	5kg & 10kg bucket.



**Corporate Office:**

601, Corporate Arena, Off. Aarey Piramal Cross Rd., Goregaon (W), Mumbai - 400104  
**Tel:** 022-46038393 **Email:** [info@aquaproofindia.com](mailto:info@aquaproofindia.com) | **Website:** [www.aquaproofindia.com](http://www.aquaproofindia.com)