



## NSA<sup>®</sup> NO.1 SILVER

(Tile Fixing Adhesive (Type - I))

**NSA No.1 Silver** is a cement based material for fixing tiles on the floor. It is a coarse powder. It is easy to use, very economical and has excellent bonding and water proofing properties.

**WHERE TO USE:** It can be used for fixing of tiles on floors.

### HOW TO USE:

**(A) SURFACE PREPARATION:** The floor which is to be tiled should be pre-cleaned to remove all traces of coating, oil, grease or other such contaminations.

**(B) MIXING:** NSA No. 1 Silver powder is to be mixed with water at a volumetric ratio of 3.5:1. Take the required quantity of water in a ghamela and mix the NSA No. 1 Silver powder gradually to achieve a paste. Allow the material to stand for 5-7 minutes for the polymers to get activated. Then remix and apply the material by a notched trowel or any such suitable tool.

**(C) APPLICATION:** Generally tile fixing is done by two methods- buttering method, notched trowel method. NSA No.1 Silver can be used for both types of applications. In buttering method, the prepared paste is applied evenly behind the dampened tiles, then fixed on the floor. In notched trowel method, the prepared paste is applied by a notched trowel on the floor first and then combed evenly. The dampened tiles should be pressed over the combed adhesive mortared floor.



①

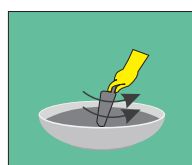

②



③

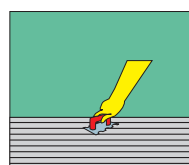

④



⑤

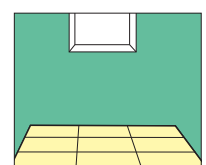

⑥

**COVERAGE:** 20kg of NSA No.1 Silver covers approximately 30-40sq.ft. on smooth and even surface at 2mm thickness.

**ADVANTAGES:**

- It can be applied even at a low thickness of 2mm with excellent bonding properties, hence it provides more coverage.
- It has excellent bonding properties and it is not necessary to hack the floor or use a mechanical key.
- It waterproofs the tiled floor.
- It is a self-curing material & requires no extra curing.
- It stops shrinkages of cement hence stops cracking of tiles.

**POT LIFE:** NSA No.1 Silver mixed with water can be used within one hour at an ambient temperature of 30°C. However factors like temperature, humidity, wind will affect the pot life.

**SETTING TIME:** NSA No.1 Silver sets 24 hours time at an ambient temperature of 30°C. However factors like temperature, humidity, wind will affect the setting time.

**STORAGE:** Keep the material in a cool, dry place since it is a cement based material. NSA No.1 Silver should not be exposed to direct atmospheric conditions. A partially used bag should be stored in airtight conditions.

**PRECAUTION:** NSA No.1 Silver is recommended for the regular tiles only.

SHELF LIFE:	PACKAGING:
For better result use within 12 months from the date of manufacturing.	20 & 50kg bag.

**Corporate Office:**

601, Corporate Arena, Off. Aarey Piralal Cross Rd., Goregaon (W), Mumbai - 400104  
Tel: 022-46038393 Email: [info@aquaproofindia.com](mailto:info@aquaproofindia.com) | Website: [www.aquaproofindia.com](http://www.aquaproofindia.com)



## NSA® GOLD

(Tile On Tile/Wall Fixing Adhesive (Type - II))

**NSA Gold** is a cement based material for fixing ceramic tiles on smooth floors, walls and on existing tiles. It is a coarse powder. It is easy to use and very economical. NSA Gold has excellent bonding and water proofing properties.

**WHERE TO USE:** NSA Gold is a self-curing material and no other extra curing is required. It can be applied even at low thickness of 2mm with excellent bonding properties, hence it provides more coverage. NSA Gold is a grey cement based material for fixing ceramic tiles vitrified on smooth floors, walls and on existing tiles.

### HOW TO USE:

**(A) SURFACE PREPARATION:** The floor/wall which is to be tiled should be pre-cleaned to remove all traces of paint, coating, oil, grease or other such contaminants.

**(B) MIXING:** NSA Gold powder is to be mixed with water at a volumetric ratio of 3.5:1. Take the required quantity of water in a ghamela and mix the NSA Gold powder gradually to achieve a paste. Allow the material to stand for 5-7 minutes for the polymers to get activated. Then remix and apply the material by a notched trowel or any such suitable tool.

**(C) APPLICATION:** Generally, tile fixing is done by two methods- buttering method, notched trowel method. NSA Gold can be used for both types of applications. In buttering method, the prepared paste is applied evenly behind the dampened tiles, then fix on the floor/wall. In notched trowel method, the prepared paste is applied by a notched trowel on floor first and combed evenly. The dampened tiles should be pressed over the combed adhesive mortared floor/walls.

### ADVANTAGES:

- It has excellent bonding properties.
- It waterproofs the tiled surface.
- It is a self-curing material and hence no other extra curing is required.
- It can be applied even at a low thickness of 2mm. with excellent bonding properties, hence it provides more coverage.
- It holds the tile very strongly and thus tiling on the walls can be done in a top-to-bottom manner.

**POT LIFE:** NSA Gold mixed with water can be used within one hour at an ambient temperature of 30°C. However factors like temperature, humidity and wind will affect the pot life.

**COVERAGE:** 20kg of NSA Gold covers approximately 30-40 sq.ft. on smooth and even surface at 3mm thickness.

**STORAGE:** Keep the material in a cool, dry place since it is a cement-based material.

**PRECAUTION:** NSA Gold should not be exposed to direct atmospheric conditions. A partially used bag should be stored in air tight condition. It is recommended for the regular tile size 2'x2' only.

SHELF LIFE:	PACKAGING:
For better result use within 12 months from the date of manufacturing.	20kg bag.

### TECHNICAL SPECIFICATIONS:

TEST DESCRIPTION	TEST METHOD	RESULT
Physical appearance	Visual	Free flowing powder
Colour	Visual	Grey
Mixing ratio	Internal	3 : 1
Pot life ratio	IS 15477 : 2004	> 30 minutes
Open time @ 30°C	IS 15477 : 2004	>15 minutes
Adjustability @ 30°C	IS 15477 : 2004	05 - 10 minutes
Setting time	Internal	24 hrs
Tensile adhesion	IS 15477 : 2004 Dry condition after 14 days	>1.00 N/mm <sup>2</sup>
Shear adhesion	IS 15477 : 2004 Dry condition after 14 days	>10.00kN

### Corporate Office:

601, Corporate Arena, Off. Aarey Piramal Cross Rd., Goregaon (W), Mumbai - 400104  
 Tel: 022-46038393 Email: [info@aquaproofindia.com](mailto:info@aquaproofindia.com) | Website: [www.aquaproofindia.com](http://www.aquaproofindia.com)





## NSA® RUBY

(Vitrified Fixing Adhesive)

**NSA Ruby** is a white cement based material for fixing marble stones over the floors and walls. Marble has low absorption. Marble is fixed with neat white or grey cement. When grey cement is used, after some time black or grey specks appear over the marble's surface. This common problem affects the aesthetic beauty of expensive marble. Since cement tends to shrink, marble fixed with neat white cement will detach from the surface very quickly. Neat cement mortar is applied at a thickness of 5mm - 10mm for bonding the marble and so the mortar is not evenly spreadable behind the marble, resulting in hollow spaces. Due to this, water leakage may occur. To overcome this problem, NSA Ruby is designed with extra bonding agents and other performance enhancing aids to boost its adhesive properties.

**WHERE TO USE:** It can be used for fixing of marble on floor & walls.

**HOW TO USE:** NSA Ruby powder is to be mixed with water at a volumetric ratio of 3.5:1. Take the required quantity of water in a ghamela and mix the NSA Ruby powder gradually to achieve a paste. Allow the material to stand for 5-7 minutes for the polymers to get activated. Then remix and apply the material by a notched trowel or any suitable tools.

### ADVANTAGES:

- It is self curing material than doesn't shrink and bonding is excellent.
- It can be applied even at low plaster thickness of 2mm with excellent bonding properties.
- Stone's aesthetic beauty of color is protected with NSA Ruby.
- It is durable and long lasting.
- It waterproof's the surface and it is economical in use.
- It is easy to use and gives more coverage to mark overall cost economy.

**COVERAGE:** 20kg of NSA Ruby covers approximately 30-35 sq.ft. on smooth & even surface at 3-4mm thickness.

**STORAGE:** Keep the material in a cool, dry place, since it is a cement-based material. NSA Ruby should not be exposed to direct atmospheric conditions. A partially used bag should be stored in airtight conditions.

**PRECAUTION:** NSA Ruby should not be exposed to direct atmospheric conditions. A partially used bag should be stored in air-tight conditions.

SHELF LIFE:	PACKAGING:
For better result use within 12 months from the date of manufacturing.	20kg bag.

#### TECHNICAL SPECIFICATIONS:

TEST DESCRIPTION	RESULT
Physical appearance	free flowing granular powder
Colour	White
Pot Life	2 Hours
Open time	10 - 15 minutes
Temperature setting time resistance	24 Hrs
Mixed Density	1.80 - 1.85 g/cc

#### Corporate Office:

601, Corporate Arena, Off. Aarey Piralal Cross Rd., Goregaon (W), Mumbai - 400104  
 Tel: 022-46038393 Email: [info@aquaproofindia.com](mailto:info@aquaproofindia.com) | Website: [www.aquaproofindia.com](http://www.aquaproofindia.com)



## NSA® DIAMOND

(Moiser & Marble Fixing Adhesive (Type - III))

**NSA Diamond** is a white cement based material for fixing vitrified tiles and glass tiles over concrete or plaster surface. Vitrified tiles like marbo granite and glass mosaic tiles are non-porous, non-absorbing and heavier, and thus fixing them with conventional method is not desirable. NSA Diamond is ideal for fixing these with excellent bonding properties.

**Its available in both grey and white colour.**

**WHERE TO USE:** For fixing of glass & vitrified tiles on floor & walls.

### HOW TO USE:

**(A) PREPARATION:** The surface, which is to be tiled, should be pre-cleaned to remove all traces of oil, grease or other such contaminates which affects adhesion.

**(B) MIXING:** NSA Diamond powder is to be mixed with water at a volumetric ratio of 3:1. Take the required quantity of water in a clean ghamela and mix NSA Diamond powder gradually to achieve a paste. Allow the material to stand for 5-7 minutes for the polymer to get activated. Then remix and apply the material by a trowel or any such suitable tool.

**(C) APPLICATION:** Fixing of vitrified tiles like marbo granite can be done by two methods- buttering method and notched trowel method. The prepared paste is applied on the surface and combed evenly. The tiles should be pressed over the combed adhesive mortar. Glass mosaic tiles are fixed with utmost care. The prepared paste is to be spread over the surface at 1 or 2mm thickness evenly and glass mosaic tiles are pressed onto the applied mortar in patch manner. Glass mosaic tiles are tiny in size and fixed in a cluster manner to tackle about 10 sq.ft.

### ADVANTAGES:

- It has very good bonding and is also non-porous. Thus it is deal for vitrified tiles.
- It doesn't shrink as it is self-curing material which requires no care.
- It saves the aesthetic beauty of glass/vitrified tiles.
- It water proofs the tile surface.
- It water can be applied at a low thickness of 2mm with excellent bonding properties.
- It gives very good coverage.

**POT LIFE:** NSA Diamond mixed with water can be used for an hour at an ambient temperature of 30°C. However, factors like temperature, humidity and wind will affect the pot life.

**COVERAGE:** 20kg of NSA Diamond covers approximately 40-50 sq.ft. on smooth & even surface at 2-3mm thickness.

**STORAGE:** Keep the material in a cool and dry place. Since it is cement based material, NSA Diamond should be stored in airtight condition.

**PRECAUTION:** Fixing of glass tiles requires skilled or trained workers only.

SHELF LIFE:	PACKAGING:
For better result use within 12 months from the mfg date.	20kg bag.

### TECHNICAL SPECIFICATIONS:

TEST DESCRIPTION	RESULT	
Physical appearance	Free flowing powder	
Colour	Grey / White	
Mixing ratio (p.b.s. - part by weight)	1 p.b.w. water to 3 p.b.w. adhesive	
Bed thickness	2-6	Walls: Use thin bed trowel
		Floor: Use thin bed trowel
Pot life @ 27 ± 1°C	2 Hours	
Open time @ 27 ± 1°C	> 15 minutes	
Adjustability @ 27 ± 1°C	05 - 10 minutes	
Setting time	24 Hours	
Tensile adhesion Dry condition after 14 days	>0.75 N/mm <sup>2</sup>	
Shear adhesion Dry condition after 14 days	>8.00 kN	

#### Corporate Office:

601, Corporate Arena, Off. Aarey Piralal Cross Rd., Goregaon (W), Mumbai - 400104  
 Tel: 022-46038393 Email: [info@aquaproofindia.com](mailto:info@aquaproofindia.com) | Website: [www.aquaproofindia.com](http://www.aquaproofindia.com)



## NSA® PLATINUM

(Strong Adhesive For Tile)

**NSA Platinum** is a premium white & grey cement based highly polymer modified wall/floor adhesive for fixing different kinds of stone & tiles.

**WHERE TO USE:** It can be used for fixing tiles on outer walls. Also suitable for marble, granite and other natural stone in interior & exterior locations.

### HOW TO USE:

**(A) SURFACE PREPARATION:** The surface, which is to be tiled, should be pre-cleaned to remove all traces of oil, grease or other such contaminants which affects adhesion.

**(B) MIXING:** NSA Platinum powder is to be mixed with water at a volumetric ratio of 3 parts of NSA Platinum to 1 part of water. Take the required quantity of water in a clean ghamela and mix NSA Platinum powder gradually to achieve a paste. Allow the material to stand for 5–7 minutes for the polymer to get activated. Then mix and apply the material by a trowel or any such suitable tool.

**(C) APPLICATION:** Fixing of granite or vitrified tiles like marbo granite can be done by two methods– buttering method and notched trowel method. A prepared paste is applied on the surface and combed evenly. The tiles should be pressed over the combed adhesive mortar. Tiles are fixed with utmost care, the prepared paste is to be spread over the surface at 2 or 3mm thickness evenly and tiles are pressed onto the applied mortar in a patch manner.

### ADVANTAGES:

- NSA Platinum waterproofs the tile surface.
- It has very high performance and strength.
- It has excellent water resistance.
- Being high bonding, it can be used on any type of surfaces.
- It is highly recommended for outer cladding work.
- It is premium grade multi use adhesive.
- It has excellent tensile & shear adhesion.
- It doesn't shrink, as it is self curing material which requires no care.

**COVERAGE:** Approx. 25-30 sq.ft. @ 3mm thickness per 20kg of bag.

**STORAGE:** Keep the material in a cool and dry place. Since it is a cement based material NSA Platinum should not be exposed to atmospheric conditions. A partially used bag should be stored in airtight condition.

**PRECAUTION:** NSA Platinum should not be exposed to direct atmospheric conditions.

SHELF LIFE:	PACKAGING:
For better result use within 12 months from the mfg date.	20kg bag.

### TECHNICAL SPECIFICATIONS:

TEST DESCRIPTION	RESULT	
Physical appearance	Free flowing granular powder	
Colour	Grey / White	
Chemical base	Cementitious mortar modifies with polymers	
Mixing ratio (p.b.s. - part by weight)	1 p.b.w. water to 3 p.b.w. adhesive	
Powder Density	1.5 - 1.60 g/cc	
Bed thickness	3-5 mm	Walls: Use thin bed trowel
		Floor: Use thin bed trowel
Pot life @ 27 ± 1°C	1 - 1½ Hours	
Setting time	24 Hours	
Rectification time @ 27 ± 1°C	10 - 15 minutes	
Temperature resistance	-25°C to 150°C	
Tensile adhesion strenght 28 days	>0.5 Mpa	
Shear adhesion strenght 28 days	>5 Mpa	

#### Corporate Office:

601, Corporate Arena, Off. Aarey Piralal Cross Rd., Goregaon (W), Mumbai - 400104  
 Tel: 022-46038393 Email: [info@aquaproofindia.com](mailto:info@aquaproofindia.com) | Website: [www.aquaproofindia.com](http://www.aquaproofindia.com)



## NSA® FLEX 40

(Strong Adhesive For Stone & Cladding.)

**NSA FLEX 40** is a highly polymer modified, flexible, cementitious, high performance adhesive for fixing different types of tiles and natural stone on wall and floor where slight movement & vibration is expected. Also suitable for fixing tiles and/or stone on outer walls at high rise building or any type cladding.

**WHERE TO USE:** It can be used for interior & exterior application of granite, marble, ceramic, vitrified tiles and natural stone. It is suitable for plaster, cement screeds, plaster boards and pre-cast concrete surfaces.

### HOW TO USE:

**(A) SURFACE PREPARATION:** Surface must be free of dust, oil and grease, dry and free from moisture. If any such contaminants are found, clean thoroughly by dry brushing or any other suitable method. Ensure that the surface is flat, stable, well cured, adhered and has no absorption. Correct and repair undulation/damage on the surface at least 72 hours before the application of NSA FLEX 40.

**(B) MIXING:** Mix 3 parts of NSA FLEX 40 to 1 part of water gradually by using suitable stirrer to achieve a smooth and workable paste. After mixing, allow the paste to stand for 5 minutes to get the chemical activated.

**(C) APPLICATION:** Apply thin/thick layer of NSA FLEX 40 over the surface with the smooth edge of a trowel and comb the applied adhesive to achieve the desired thickness. Press the tiles onto NSA FLEX 40 to ensure good adhesion properties.

### ADVANTAGES:

- It is flexible adhesive for application on different types of surface.
- It is ready to use, single component.
- Crack resistant & waterproof.
- Suitable for different kind of tiles, granite, marble and stone in large formats application.
- Non slip.
- Excellent adhesion properties.
- Self curing product.
- No shrinkage.
- Internal and external use.

### COVERAGE:

20-25sq.ft./20kg bag at 3-4mm thickness.

12-15sq.ft./20kg bag at 7-8mm thickness

**STORAGE:** Keep the material in a cool and dry place. Since it is cement based material, NSA FLEX 40 should not be exposed to direct atmospheric conditions. A partially used bag should be stored in airtight conditions.



**PRECAUTION:** Fixing of stone & tiles in the long format requires skilled or trained worker only.

SHELF LIFE:	PACKAGING:
For better result use within 12 months from the mfg date.	20kg bag.

### TECHNICAL SPECIFICATIONS:

PROPERTIES	RESULT
Physical appearance	free flowing granular powder in white colour
Bulk Density	1.30 - 1.40 g/cc
Bed thickness	Thin layer - 3 to 4 mm Thin layer - 7 to 8 mm
Set time	6 - 7 hours
Open time tile fixing (27 ± 2°C)	30 minutes
Pot life	90 minutes (At 25°C)
Drying time	24 hours
Tensile adhesion strenght @ 28 days	Intitial > 1 Mpa After immersion > 1 Mpa >
Compressive strenght @ 28 days	7 Mpa

#### Corporate Office:

601, Corporate Arena, Off. Aarey Piralal Cross Rd., Goregaon (W), Mumbai - 400104  
 Tel: 022-46038393 Email: [info@aquaproofindia.com](mailto:info@aquaproofindia.com) | Website: [www.aquaproofindia.com](http://www.aquaproofindia.com)



## AQUA SCREED™

(Bedding Mortar)

**Aqua Screed** is a single component cementitious high strength bedding mortar. It is ready to use dry powder for application on existing substrate before the installation of tile and stone. It is a blend of Portland cements, powder additives and graded aggregates. It requires only the addition of clean water on site.

**WHERE TO USE:** For used in both residential and commercial in dry and wet areas.

### HOW TO USE:

**(A) SURFACE PREPARATION:** Ensure that substrate is free from oil, paint and other contaminants that may reduce or prevent proper adhesion. Also ensure that there is absolutely no free water prior to bedding in.

**(B) MIXING:** Aqua Screed can be mixed by hand or by mortar mixer machine. Mix 40 kg bag with 4.5 to 5 litre of clean water.

**(C) APPLICATION:** Place the Aqua Screed within 20 minutes of mixing in order to maintain workability. Aqua Screed should be applied by trowel. Use a dampened steel trowel to finish. On completion of the application, entire area should be thoroughly cured with water.

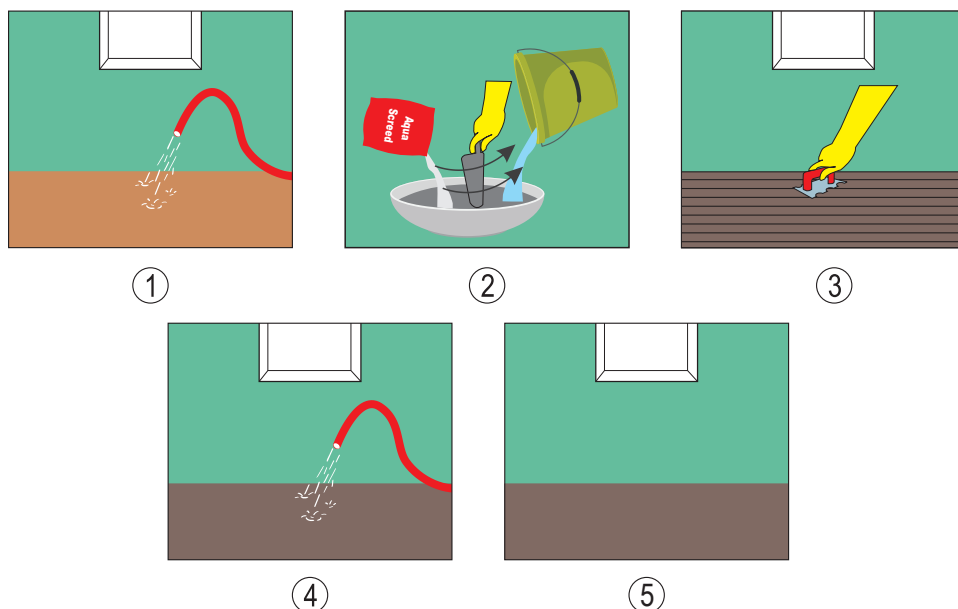

**ADVANTAGES:**

- Easy to use
- Pre blended
- High strength
- Low wastage
- Better finish
- Requires only water addition

**STORAGE:** Keep the material in a cool and dry place. Since it is cement based material, Aqua Screed should not be exposed to direct atmospheric conditions. A partially used bag should be stored in airtight conditions.

SHELF LIFE:	PACKAGING:
For better result use within 12 months from the mfg date.	40kg bag.

**Corporate Office:**

601, Corporate Arena, Off. Aarey Piralal Cross Rd., Goregaon (W), Mumbai - 400104  
**Tel:** 022-46038393 **Email:** [info@aquaproofindia.com](mailto:info@aquaproofindia.com) | **Website:** [www.aquaproofindia.com](http://www.aquaproofindia.com)



## TYLE-O-FIX™

(Tile Fixing Admixture)

**Tyle-O-Fix** is a white polymer based liquid additive used to make mortars of high bond strength. The mortar so made is waterproof and can be used for fixing ceramic, marble, cement tiles etc. on floors and walls.

**WHERE TO USE:** For fixing tiles over tiles, floors & cladding for all types of cement, glazed and ceramic tiles.

**HOW TO USE:** Thoroughly clean the surface on which the tiles are to be fixed with a wire brush hammer or a scraping machine. Dry mix cement and fine sand in the proportion of 1:2. To this mixture add Tyle-O-Fix in the ratio of 7.5 liters per 50kg of cement and mix thoroughly by adding water to get a uniform mortar of thick consistency. Apply the prepared mortar at 3mm thickness. While the mortar is still fresh, press the tiles onto the mortar in ordinary tile fixing manner.

### ADVANTAGES:

- It is an admixture in a cement/sand mortar in a ratio of 1:2.
- It is easy to use.
- Better adhesion.
- It is very economical.
- Also, it is chemically resistant.
- It is flexible and resistant to thermal impact, shock and is non-toxic.

**STORAGE:** Store unopened in normal & dry condition.

**DOSAGE:** 1Ltr of liquid per bag of cement mortar in 1:2 ratio and covers approximately 18 sq.ft. at 3mm thickness.

**SHELF LIFE:**

For better result use within one year, from the date of manufacturing.

**PACKAGING:**

5, 10 & 20Ltr Drum.

**TECHNICAL SPECIFICATIONS:**

PROPERTIES	RESULT
Physical appearance	Milky white liquid
Solubility	Fully miscible with water
Density	1.03 ± 0.01
pH	8 - 9
Toxicity	Non - toxic
Anti - foam	Yes

**Corporate Office:**

601, Corporate Arena, Off. Aarey Piralal Cross Rd., Goregaon (W), Mumbai - 400104  
 Tel: 022-46038393 Email: [info@aquaproofindia.com](mailto:info@aquaproofindia.com) | Website: [www.aquaproofindia.com](http://www.aquaproofindia.com)



## TYLE GROUT

(Cementitious Tile Joint Filler)

**Tyle Grout** is the finest cement based tile grouting filler ready mix powder, manufactured by experts in the field. It is available in a range of 30 beautiful shades with 1kg and ½kg pouches. It is a powder form material which requires only addition of water before use.

**WHERE TO USE:** It can be applied over internal, external floor & wall tile joints.

### HOW TO APPLY:

**(A) SURFACE PREPARATION:** Joints in which Tyle Grout is to be applied should be cleaned and made free from any contaminants which will affect adhesion.

**(B) MIXING:** Tyle Grout premix powder should be used for filling any type of tile joints only after 24 hours of fixing the tiles. Mix Tyle Grout with water in the ratio of three part powder and one part water by volume. Let the mixed paste of Tyle Grout remain in the pan for 10 to 15 minutes. Apply the paste to fill joints with a sponge/squeegee. Remove surplus paste of Tyle Grout with a damp sponge before it dry. Allow the Tyle Grout to naturally cure (completely dry) for 24 hours after application.

**(C) APPLICATION:** Mix Tyle Grout with water. Apply by hand or with squeegee. Clean tile area after 2 hours by sponge and by TyleKleen after 24 hours.

**COVERAGE:** 1kg pack will cover area in sq.ft. as per the tile sizes (ref. shade card).

### ADVANTAGES:

- It is durable and imparts excellent water resistance and water proofing properties.
- It does not shrink or cause cavities which accumulate dirt.
- It has excellent scratch and mark resistance.
- It is a do-it-yourself product and thus application is very simple and easy.
- Tyle Grout with range of colors adds the aesthetic beauty to the floors and walls which are tile.
- It is durable & economical.



**STORAGE:** Store unopened in normal & dry condition.

**COVERAGE CHART:** One kg. pack of TyleGrout is enough to cover the following areas in square feet as per tile size and joint widths given below.

TILE SIZE		TILE JOINT WIDTH		
25x25x6mm	2.1	1.1	0.8	0.7
100x100x12mm	5.4	2.7	1.8	1.4
200x200x9mm	10.8	5.5	3.7	2.8
400x400x9mm	21.6	10.8	7.3	5.5

SHELF LIFE:	PACKAGING:
For better result use within one year, from the date of manufacturing.	500gm & 1kg pouches with 12 pouches in master carton & 10kg bag.



**Corporate Office:**

601, Corporate Arena, Off. Aarey Piramal Cross Rd., Goregaon (W), Mumbai - 400104  
**Tel:** 022-46038393 **Email:** | info@aquaproofindia.com | **Website:** www.aquaproofindia.com





## TYLE GROUT SEALER

(White Colour Polymer Base Admixture)

**Aquaproof Tyle Grout Sealer** is a white color liquid which creates an invisible shield to repel dirt so that it doesn't penetrate the grout. It has a unique, non-silicone formula that provides a curable sub-surface and a protective barrier against soil on tile and grout in showers and restrooms. Treating floors and walls with Tyle Grout Sealer ensures that the surfaces are kept to a high standard of appearance with reduced maintenance.

**WHERE TO USE:** It can be used along with tile grout to fill joints of tile & stone. It can also be used on top of tile grout to be filled in the gap.

### HOW TO APPLY:

**(A) SURFACE PREPARATION:** Remove any large debris such as grease, dirt, and other contaminants before coating. Sweep with broom or brush. If extremely dirty, clean with tile cleaner. Remove cleaning solution with a wet vacuum, rinse with clean water and allow surface to dry completely before applying.

**(B) APPLICATION:** Floor must be completely dry to the touch before application. Do not dilute. You can also mix it with tile grout. Product may be applied with a saturated brush, roller or micro cloth. After seal remains on the surface for no more than 10 minutes, mop or wipe the surface. Highly porous surfaces will require two coats. Apply the second coat when the first coat is dry (after 20-30 minutes). Wait at least 4 hours before opening to light traffic for the best protection.

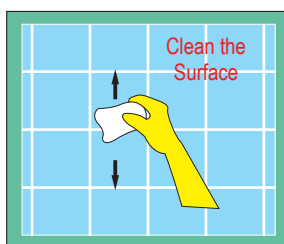

①

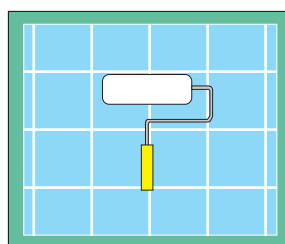

②

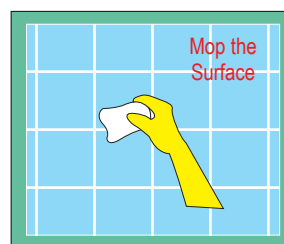

③

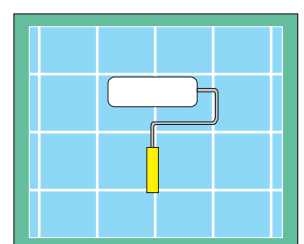

④

**ADVANTAGES:**

- Non-gloss seal for porous grout.
- Contains no volatile organic compounds.
- Water-based formula is easy to apply.

**COVERAGE:** Depends on the width of tile joints

**STORAGE:** Store in dry and cool place, away from direct sunlight.

**PRECAUTION:** Do not over mix the mater

SHELF LIFE:	PACKAGING:
For better result use within one year, from the date of manufacturing.	150ml bottle, 500ml & 1Ltr can.

**TECHNICAL SPECIFICATIONS:**

PROPERTIES	RESULT
Colour	White
Scent	Mild
Appearance	Translucent
pH (Concentrate)	4.00 - 5.00
Dilution Rate	Use as it is

**Corporate Office:**

601, Corporate Arena, Off. Aarey Piralal Cross Rd., Goregaon (W), Mumbai - 400104  
 Tel: 022-46038393 Email: [info@aquaproofindia.com](mailto:info@aquaproofindia.com) | Website: [www.aquaproofindia.com](http://www.aquaproofindia.com)



## AQUAPOXY™

(Epoxy Tile Grout)

**AquaPoxy** epoxy grout is a three part general purpose water clean-up epoxy system for grouting most types of ceramic tiles in demanding environments. It consists of epoxy resin, epoxy hardener and selected colored fillers. It is available in 10 colours.

**WHERE TO USE:** AquaPoxy grout can be used for internal & external wall & floor tile grouting of ceramic, vitrified tiles, marble & stone.

### HOW TO APPLY:

**(A) SURFACE PREPARATION:** Before application of AquaPoxy, ensure the tile adhesive has set firmly. Remove any loose or foreign material from the grout joints and ensure the grout joints are clean & dry.

**(B) MIXING:** AquaPoxy is a three component system for onsite mixing. Initially add the epoxy resin to the epoxy hardener to a clean container and mix thoroughly. To this mix, while stirring, gradually add the powder colour grout and mix this until lump free and uniform colour is achieved.

**(C) APPLICATION:** Using a rubber squeegee, press the grout firmly into the joints, ensuring that the joints are completely filled. Remove excess grout from the surface of the tiles with the rubber squeegee using a diagonal motion. Clean off the surplus grout from the joints and surface within 10-15 minutes. Use a damp sponge in a circular motion and keep it relative to the surface to achieve a flush joint. Do not allow water to flow or run into ungrouped joints.

### ADVANTAGES:

- Easy to use.
- Ideal for both interior and exterior application.
- High strength.
- Non-cracking or powdering.
- Chemical resistant.
- Good abrasion resistant.

**STORAGE:** Store unopened in normal & dry condition.

**PRECAUTION:** Do not add water in to the AquaPoxy. Do not apply on wet/damp tile joints. Do not over-mix the material. Ensure adequate ventilation during application in working place. Do not apply AquaPoxy at temperatures above 40°C or below 5°C. Do not allow the residue to remain on the surface more than 24 hrs. Keep out reach of children.

SHELF LIFE:	PACKAGING:
12 months from the date of manufacture.	1 & 5 kg Bucket.

#### TECHNICAL SPECIFICATIONS:

PROPERTIES	RESULT
Nature	Three Component (Hardner, Base & Filler
Appearance (Mixed)	Various Coloured Pastes
Specific Gravity (Mixed)	1.72 ± 0.02
Pot Life	Min. 45 minutes @ 30°C
Setting Time	24 hrs.
Foot Traffic	24 hrs.
Heavy Traffic	3 days
Full Cure Time	7 Days
Water Absorption	Nil.
Mix Consistency	Smooth Paste

#### Corporate Office:

601, Corporate Arena, Off. Aarey Piramal Cross Rd., Goregaon (W), Mumbai - 400104  
 Tel: 022-46038393 Email: [info@aquaproofindia.com](mailto:info@aquaproofindia.com) | Website: [www.aquaproofindia.com](http://www.aquaproofindia.com)



## AQUAPOXY KLEANER™

Epoxy Grout Cleaner (Epoxy Fixing Site Residue Cleaner)

**AquaPoxy Epoxy Kleaner** is a non-acidic cleaner to remove traces of epoxy grout from tile, ceramics, glass mosaic, concrete and stone surfaces. It is used to remove residues, stains and marks of epoxy grout without giving off hazardous fumes.

**WHERE TO USE:** AquaPoxy Epoxy Kleaner can be used wherever epoxy grout is used on ceramic tiles, vitrified tiles, glass mosaic, concrete and natural stone.

**HOW TO USE:** Apply **AquaPoxy Epoxy Kleaner** over the affected area. Wait for 10-15 minutes for the chemical to get activated. Remove epoxy film using a clean cloth or brush. Multiple applications may be necessary. Clean the area with water and allow it to dry.

### ADVANTAGES:

- Fast acting formula.
- Easy to use.
- Non-acidic.
- Non-corrosive.
- Can be used on multi-surfaces .
- High strength.
- Does not damage tile/mosaic surfaces.

**STORAGE:** Stored unopened in normal & dry condition.

**PRECAUTIONS:** Before using AquaPoxy Epoxy Kleaner, protect all surfaces which could be damaged in direct contact with the product. Do not over-mix the material. Ensure adequate ventilation during application in working place. Keep out of reach of children.

SHELF LIFE:	PACKAGING:
For better result use within 12 months from the date of manufacturing.	1Ltr bottle & 12 bottles in a carton.

**TECHNICAL SPECIFICATIONS:**

PROPERTIES	RESULT
Physical appearance	Clear liquid
pH	Mild
Appearance	8 (5% in water)
Specific gravity	1.03 ± 0.02

**Corporate Office:**

601, Corporate Arena, Off. Aarey Piramal Cross Rd., Goregaon (W), Mumbai - 400104  
**Tel:** 022-46038393 **Email:** [info@aquaproofindia.com](mailto:info@aquaproofindia.com) | **Website:** [www.aquaproofindia.com](http://www.aquaproofindia.com)



## **TYLEKLEEN™**

(Tile Cleaning Agent)

**TyleKleen** is a high quality, effective & mild acid based liquid detergent and degreasing solution for cleaning tiles, wash basins, etc. as well as plastic/metal buckets of those white/yellow stains which ordinary detergent cannot remove. This is an ideal cleaning material for surfaces before application of epoxy products.

**WHERE TO USE:** Use to clean tiles, ceramic, vitrified tiles, bath tubs, wash basin & concrete etc.

**HOW TO APPLY:** Pour TyleKleen in a medium size bucket and add sufficient water to dilute. Stir well. Use a sponge/clean cloth dipped in TyleKleen to wipe the dirt from tile surfaces.

**COVERAGE:** One liter of TyleKleen can give coverage up to 50-60sq.ft. depending upon the condition of the surface to be cleaned.

### **ADVANTAGES:**

- Multi purpose cleaning solution for tiles.
- Removes stains.
- Easy to use.
- Can be diluted with water.

**STORAGE:** Store in normal & dry condition with tightly closed container.

**PRECAUTION:** Do not pour TyleKleen into metal containers. Do not mix with other cleaner & chemicals or else the result can be dangerous. Add only water to protect adjacent surface.



SHELF LIFE:	PACKAGING:
For best results use within one year from the date of manufacturing.	500ml, 1Ltr & 5Ltr can (½Ltr - 24 cans, 1Ltr - 12 cans, 5Ltr - 4 cans in masterton)

**TECHNICAL SPECIFICATIONS:**

PROPERTIES	RESULT
Physical appearance	Lite green liquid
Odor	Slight odor
Density	1.00 ± 0.04
pH	2.00
Foam level	Low
Waiting time before rising	5 mins
Shelf life	Up to 1 year when stored in the original sealed container

**Corporate Office:**

601, Corporate Arena, Off. Aarey Piralal Cross Rd., Goregaon (W), Mumbai - 400104  
 Tel: 022-46038393 Email: [info@aquaproofindia.com](mailto:info@aquaproofindia.com) | Website: [www.aquaproofindia.com](http://www.aquaproofindia.com)



## **TYLEKLEEN HD™**

(Heavy Duty Tile Cleaning Agent)

**TyleKleen HD** is an acid based degreaser. It effectively removes grease, soap scum, tough stains and algae from areas that have been subjected to heavy use. It removes cement & paint particles from the surface.

**WHERE TO USE:** Use for cleaning of dirty ceramic tiles.

**HOW TO USE:** Mix 1 part TyleKleen HD to 2 parts of clean water. Apply solution to the surface to be cleaned. Allow for contact with the area for approx. 7-9 minutes. Thoroughly brush the area treated with the solution. Mop up the solution and rinse well with water. Heavily soiled area may require repeated application of Tyle Kleen HD.

### **ADVANTAGES:**

- Easy to apply.
- It kills germs and removes tough stains from the surface.
- It is safe and environment friendly product.

**STORAGE:** Store in dry condition & away from direct sunlight.

**PRECAUTION:** Do not pour TyleKleen HD into metal containers. Do not mix with other cleaner & chemicals or else the result can be dangerous.

SHELF LIFE:	PACKAGING:
TyleKleen HD has a shelf life of 12 month & in unopened container.	1Ltr bottle & 5Ltr industrial pack.

**TECHNICAL SPECIFICATIONS:**

PROPERTIES	RESULT
Physical appearance	Clear to amber liquid
Odor	Slight acidic
Specific gravity	1.00 ± 0.02
pH	2.00
Foam level	Low
Waiting time before rising	5 - 10 mins
Solubility	100%
Shelf life	Up to 1 year when stored in the original sealed container

**Corporate Office:**

601, Corporate Arena, Off. Aarey Piralal Cross Rd., Goregaon (W), Mumbai - 400104  
Tel: 022-46038393 Email: [info@aquaproofindia.com](mailto:info@aquaproofindia.com) | Website: [www.aquaproofindia.com](http://www.aquaproofindia.com)