



AQUAPROOF WALL CARE™ PREMIUM PUTTY

(White Cement & Imported Polymer Based Premium Quality Putty)

Aquaproof Wall Care Premium Putty is one of India's top class velvet finish premix white cement based & polymer modified putty manufactured by experts in the field. It is white cement-based putty in a powder form. It is easy to apply and very economical too. It is to be applied before painting on the plastered wall/ceiling to level the surface. It gives a smooth finish and an excellent water-resistant finishing.

WHERE TO USE: Aquaproof Wall Care Premium Putty is generally recommended as a surface leveler before painting. It is excellent for ceiling, interior and exterior portions of buildings, flats, bungalows, hospital and theater walls, educational institutes and laboratories, convention halls etc. Since UV rays do not affect it, Aquaproof Wall Care Premium Putty can be safely used on exterior facades of structures.

HOW TO USE:

(A) SURFACE PREPARATION: Walls on which Aquaproof Wall Care Premium Putty is to be applied should be cleaned and made free from contaminants, which will affect adhesion and should be pre-cleaned. Neutralize the surface with sufficient quantity of water. Apply the prepared pasty slurry over the cleaned surface and allow it to dry for 6-8 hours. The other coat must be applied at right angles to the direction of the first coat.

(B) MIXING: Aquaproof Wall Care Premium Putty powder is to be mixed with 38-42% water by weight of powder. Take approx. half the quantity of required water in bucket. Add Aquaproof Wall Care Premium Putty powder gradually and stir continuously with a flat blade or by a mechanical mixer. Add the remaining water gradually while mixing is complete, allow the mixture to stand for 10-15 minutes. Then remix and apply the material by a spatula or by a flat blade.

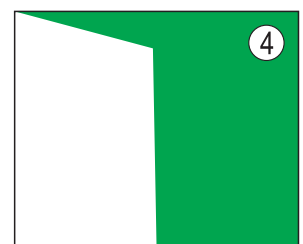
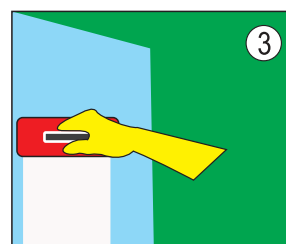
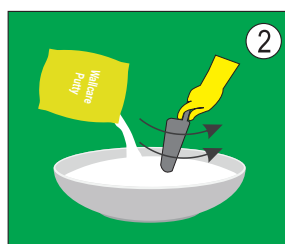
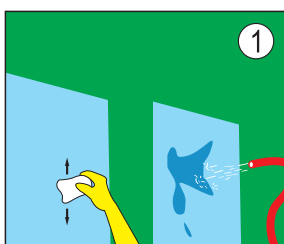

COVERAGE: A 40kg bag covers approximately 400-600 sq.ft. for a coating of 1 mm thickness.

ADVANTAGES:

- It does not require water curing.
- It is durable and imparts excellent water resistant and waterproofing properties.
- It can be applied on new as well as old surfaces as it poses excellent bonding properties.
- It should be applied for up to 2mm thickness per coat, thus small holes, crevices can be levelled but it can be applied for maximum two coats only.
- It has excellent scratch and mark resistance.
- It allows the painter the unique abilities to take the "edges".
- It can be applied on concrete, cement plastered surface.
- It gives more coverage, hence it is economical.
- It is a do-it-yourself product and thus application is very simple and easy to use.

STORAGE: Keep the material in a cool, dry place. Since it is cement based material, it should not be exposed to direct atmospheric conditions. A partially used pack should be stored in air tight conditions.

PRECAUTION: After completion of work, clean tools and vessels with water before material sets. Never apply more than 2mm at a time and do not apply more than 3mm thickness in any circumstances.

SHELF LIFE:	PACKAGING:
For better results use within 6 months from the date of manufacturing.	1, 5kg pouches & 20, 40kg bags.

Corporate Office:

601, Corporate Arena, Off. Aarey Piralal Cross Rd., Goregaon (W), Mumbai - 400104
Tel: 022-46038393 **Email:** info@aquaproofindia.com | **Website:** www.aquaproofindia.com



AQUA PLAST ACRYLIC PREMIUM PUTTY

(Water Based Acrylic Wall Putty)

Aqua Plast Acrylic Premium Putty is a ready to use water based acrylic wall putty for interiors in the paste form. It is one of the best products of its kind available in the market which provides a very strong and durable finish. It has excellent adhesion to the surface and provides quality walls and ceilings for residential or commercial constructions.

WHERE TO USE: Aqua Plast Acrylic Premium Putty should be directly applied on the surface/interior walls and ceilings with painter's knife or mason's steel trowel.

HOW TO USE:

(A) SURFACE PREPARATION: New plaster surfaces should be allowed to mature for min. 3 months. Ensure the surface is clean, dry and free from loose particles, dust, dirt, grease, wax etc. Surface imperfection/ dents/cracks should be repaired before application.

(B) METHOD OF APPLICATION: Aqua Plast Acrylic Premium Putty is ready to use and no need of dilution. Use the fine steel trowel or painter's putty knife to spread Aquaplast Premium covering the maximum surface area. The thickness of the coat should be 1 mm. After the first coat of Aquaplast Premium is dried apply a thin second coat. Thickness of both the coats should not exceed 2 mm. The drying time of each coat is around 3-4 hours. After the application and dried of final coat, smoothen the surface by rubbing gently with a '0' number sand paper or emery paper. Remove the dust using clean cloth. The Aquaplast Premium surface is now ready for painting.

COVERAGE: A 20kg bucket covers approximately 125-150 sq.ft. for a coating of 2mm thickness.

ADVANTAGES:

- It is excellent for filling and smoothening out cracks and dents on plastered wall
- It has special acrylic binders that ensure that it retains a strong grip on the wall surface.
- It also enhances breathability and lesser porosity compared to conventional putty.
- It has superior workability, ensures ease of application for fast work execution.

- It has better alkali resistance, thus making it more suitable for new walls.
- It can be applied on almost all interiorsurfaces new or old
- It is quick drying, thus ensuring faster completion of jobs

STORAGE: Store in cool and dry place. Protect from direct sunlight and rain during storage and in transit. Aqua Plast Acrylic Premium Putty when partly consumed, the remaining material in the bucket should be kept air tight

PRECAUTION: After completion of work, clean tools and vessels with water before material sets. Never apply more than 2mm at a time and do not apply more than 3mm thickness in any circumstances.

SHELF LIFE:	PACKAGING:
For better results use within 6 months from the date of manufacturing.	1, 2, 5kg cans & 10, 20kg bucket.

TECHNICAL SPECIFICATIONS:

PARAMETERS	RESULT
Colour	White
Nature	Ready to use thick paste
Finish	Smooth and even finish
Drying time	Surface dry time 30 min
Coverage	100 Sq.ft/ 25kg bag for 2 coat at 2mm thickness
Mode of application	Steel palti or trowel

Corporate Office:

601, Corporate Arena, Off. Aarey Piramal Cross Rd., Goregaon (W), Mumbai - 400104
 Tel: 022-46038393 Email: I info@aquaproofindia.com I Website: www.aquaproofindia.com